



LS80: VILLAS PROJECT IN THE HEART OF NATURE ON ASIAN ISTANBUL

REAL ESTATE INVESTMENT

Istanbul, Cekmekoy

Luxury Investing

LS LUXURY
SIGNATURE



Luxury Investing

PROPERTY DESCRIPTION

It is a villa project, located in the Asian side of Istanbul, in Cekmekoy area.

This project is being built on a land area of 11.500 sqm.

60% of the project area is dedicated for green spaces.

The project consists of 22 villas, of the types 3+1 and 4+1.



Luxury Investing

All villas in the project are being offered with a smart home system.

There is a private swimming pool and garden for each villa in the project.

The project has a comprehensive social areas, for a happy time with your family, these facilities include children's park, basketball court, gym, and more.

The project is under-construction, and it will be delivered in December 2023.

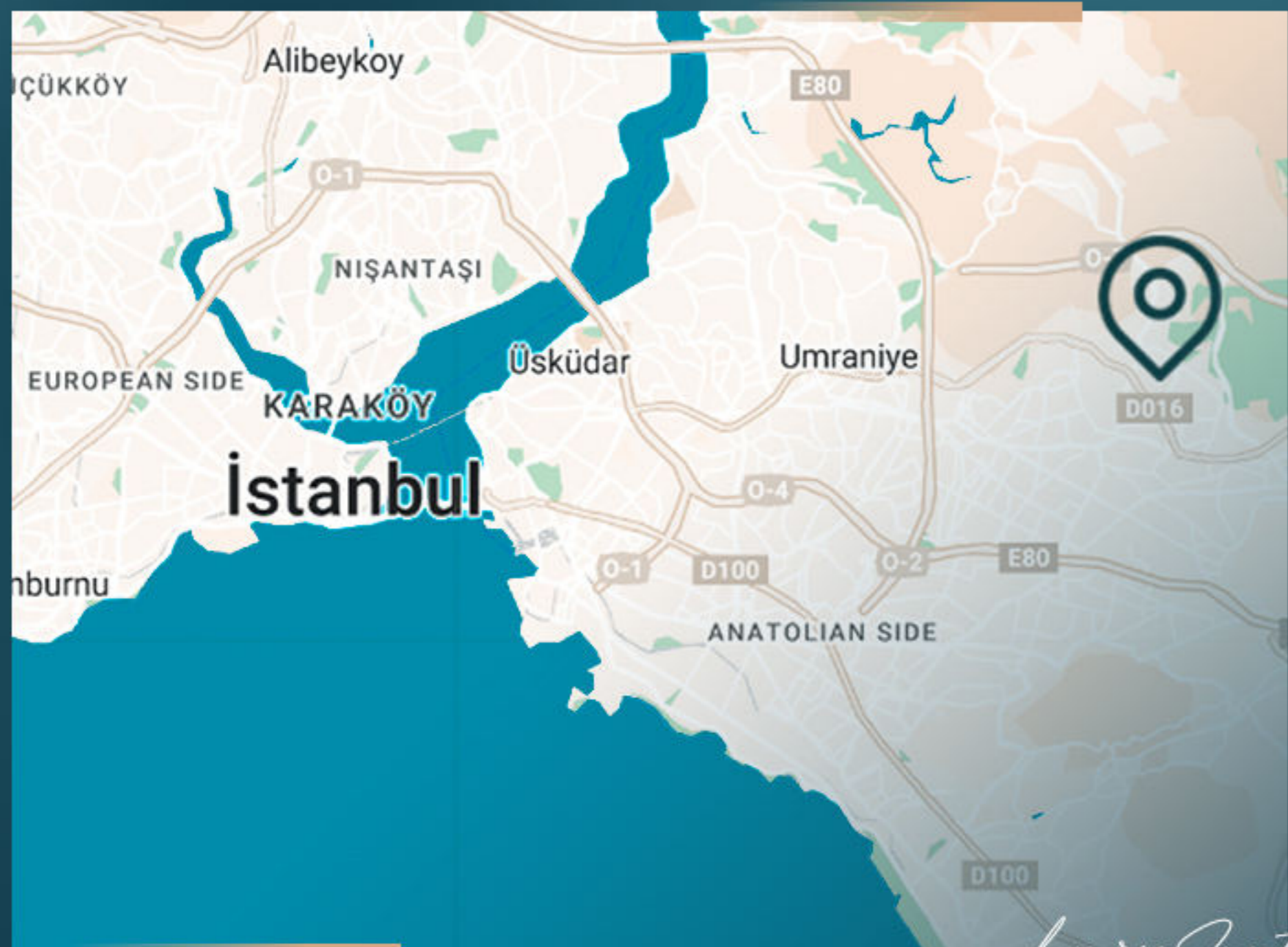

Luxury Investing

PROPERTY LOCATION

- It is 9 minutes away from the highway
- It is 25 minutes away from Sabiha Airport
- It is 10 minutes away from Amerikan College
- It is 25 minutes away from Meydan Mall
- It is 12 minutes away from hospitals
- It is 10 minutes away from Park of Istanbul



Luxury Investing

PROPERTY FEATURES



Swimming Pool



Garage



Gardens



Elevator



Gym



Sauna



Security

Luxury Investing



PROJECT
PHOTOS

REAL ESTATE INVESTMENT

Luxury Investing

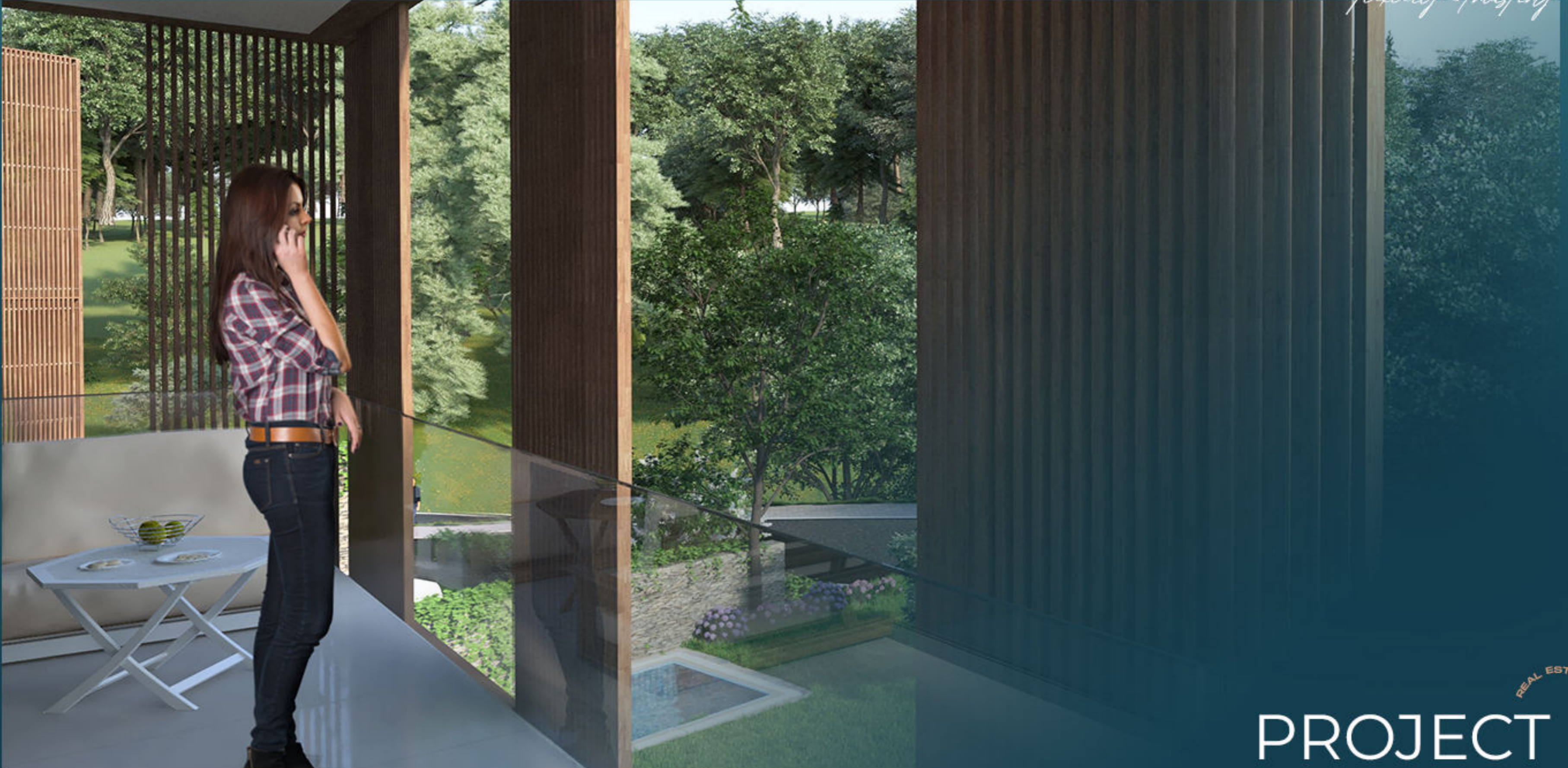

REAL ESTATE INVESTMENT
**PROJECT
PHOTOS**

Luxury Investing



REAL ESTATE INVESTMENT
**PROJECT
PHOTOS**

Luxury Investing



REAL ESTATE INVESTMENT
PROJECT
PHOTOS

Luxury Investing



PROJECT
PHOTOS

REAL ESTATE INVESTMENT

Luxury Investing



REAL ESTATE INVESTMENT
PROJECT
PHOTOS

Luxury Investing



REAL ESTATE INVESTMENT
PROJECT
PHOTOS

Luxury Investing



PROJECT
PHOTOS

REAL ESTATE INVESTMENT

Luxury Investing



PROJECT PHOTOS

REAL ESTATE INVESTMENT



PROJECT
PHOTOS

REAL ESTATE INVESTMENT



CONTACT
US

0 212 924 97 37
info@luxurysignature.net
www.luxurysignature.net

Skyland İstanbul, Huzur Mah.
Cendere Cad. 515/B Blok,
Sarıyer/İstanbul