



LS307: PRIVATE VILLAS IN
BODRUM WITH SEA AND
FOREST VIEW

Bodrum, Turkey

REAL ESTATE INVESTMENT



Luxury Investing

PROPERTY DESCRIPTION

In this project, located in Yalikavak in Bodrum, with a panoramic view of the sea and the forest, you will watch the magnificent view every day from a table from your house.

Stay away from the chaos of the center in this project that has been designed for a new lifestyle, where you will live a full-fledged and unique life for 12 months of the year.



Luxury Investing

The project has a land area of 13.000 sqm.

The project consists of 24 residential units, of the type 1+5 triplex villas, with a net area of 245 sqm, and has been built on a 13 decares of land.

Each villa has its own indoor parking lot for 2 vehicles.

Each villa in this project has a private pool and a large garden. Also, in all villas, you can enjoy the magnificent sea view.



Luxury Investing

All of the 5 rooms in the villa have separate dressing rooms, bathrooms and toilets.

You will be able to manage your home from any smart device you want with the smart systems in your home.

REAL ESTATE INVESTMENT

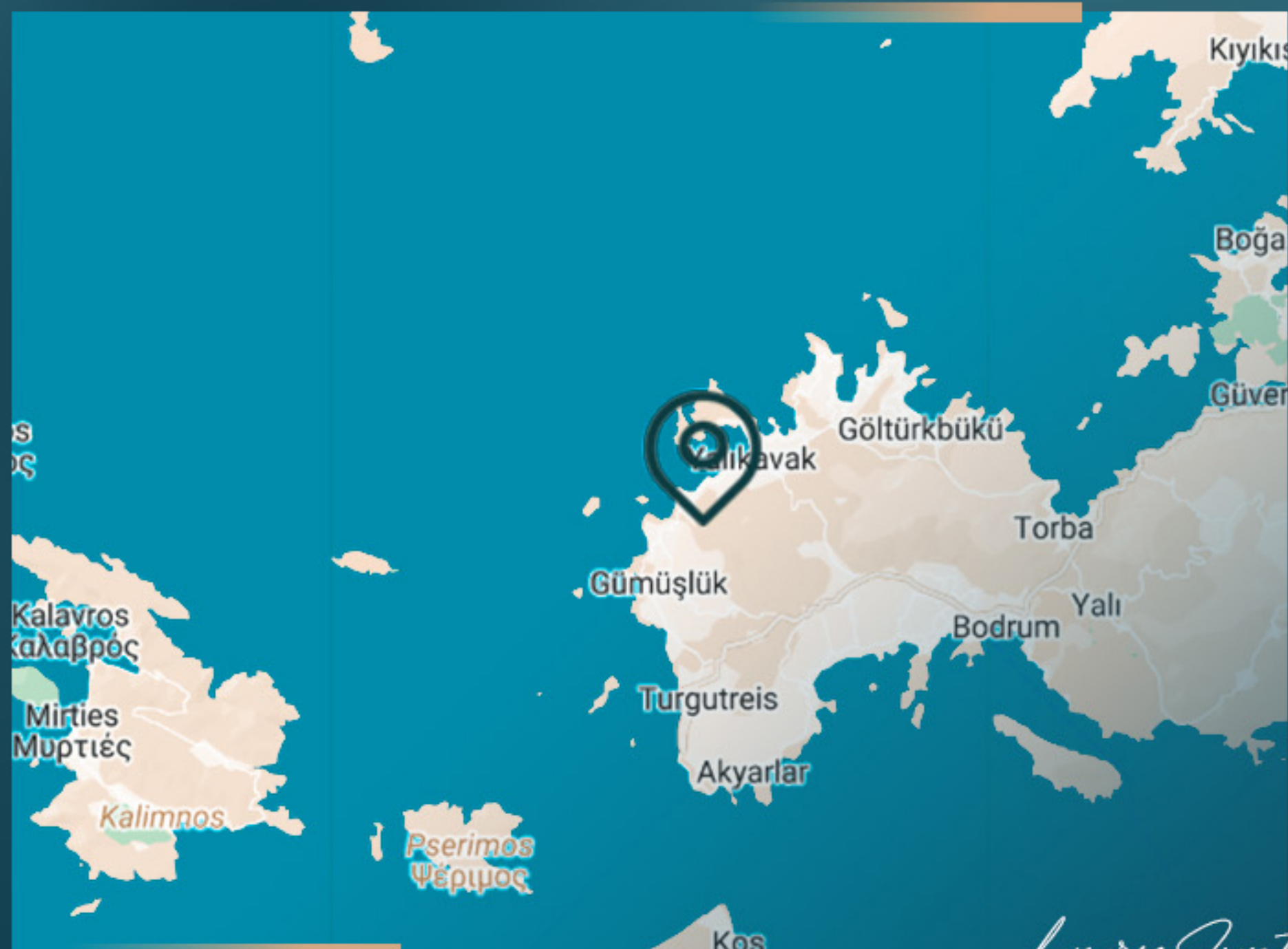

PROPERTY LOCATION

It is 4 minutes away from Yalikavak Marina

It is 9 minutes away from Gumusluk

It is 15 minutes away from Ortakent

It is 15 minutes away from Midtown Shopping Center

It is 25 minutes away from Bodrum Centre

It is 50 minutes away from Milas Bodrum Airport

Luxury Investing



Luxury Investing

PROPERTY FEATURES



Swimming Pool



Garage



Gardens



Elevator



Security

Luxury Investing



REAL ESTATE INVESTMENT

PROJECT PHOTOS

Luxury Investing



PROJECT
PHOTOS

REAL ESTATE INVESTMENT

Luxury Investing



PROJECT
PHOTOS

REAL ESTATE INVESTMENT

Luxury Investing



PROJECT
PHOTOS

REAL ESTATE INVESTMENT

Luxury Investing



PROJECT
PHOTOS

REAL ESTATE INVESTMENT

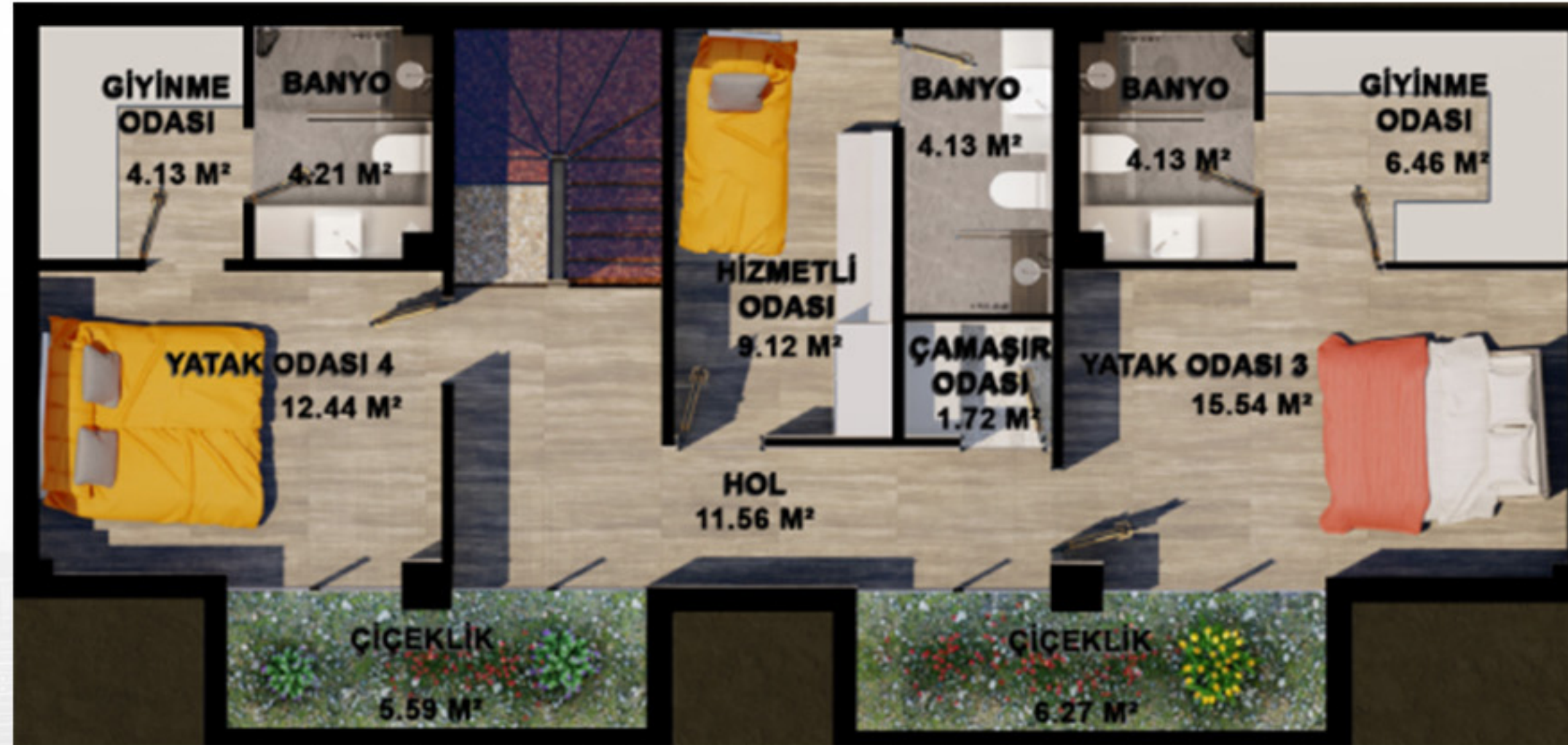







CONTACT
US

0 212 924 97 37
info@luxurysignature.net
www.luxurysignature.net

Skyland İstanbul, Huzur Mah.
Cendere Cad. 515/B Blok,
Sarıyer/İstanbul